

FAUX WOOD BLIND INSTRUCTIONS

Recommend Tools

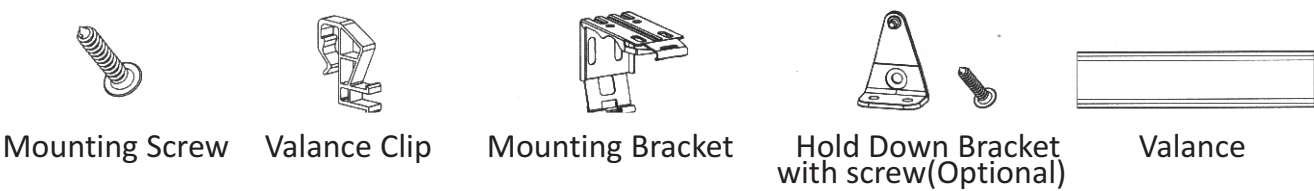

Components



Installation

1 Choose a blind position:
Inside Mount or Outside Mount.

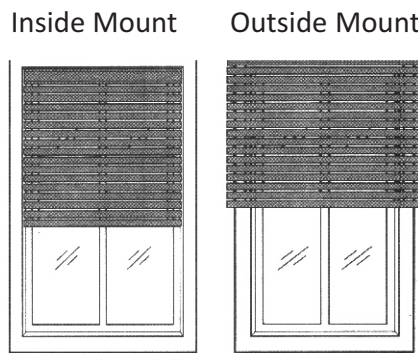

2 Inside mounting brackets. Always use at least TWO 1 1/4" Mounting screws per bracket.

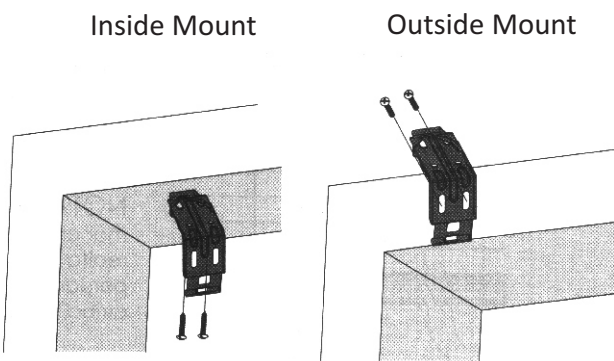

3 Mark bracket position. Brackets should not interfere with the tilt mechanism.

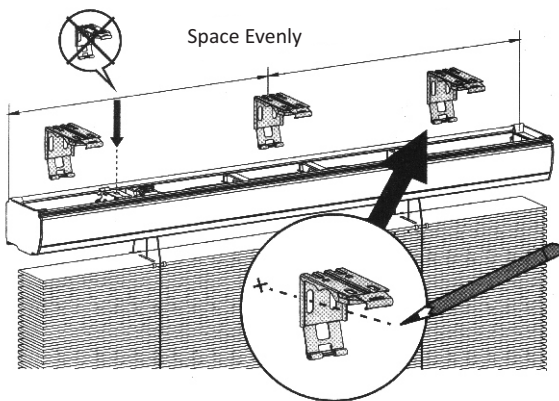

4 Mount your blind

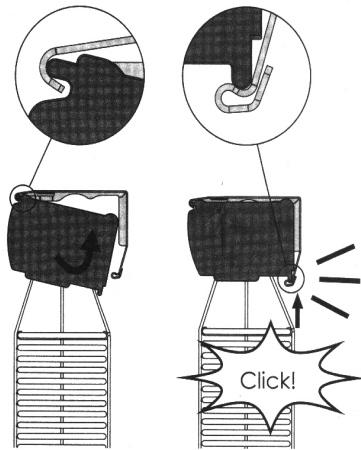

Dismount your blind

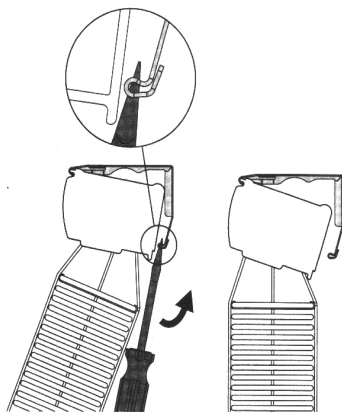

5 Attach valance clips

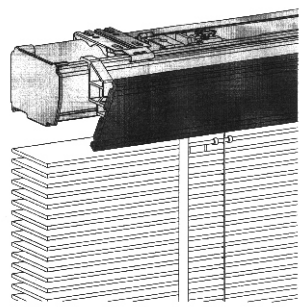
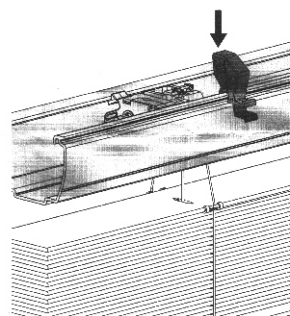

Optional Install hold down bracket

Inside Mount

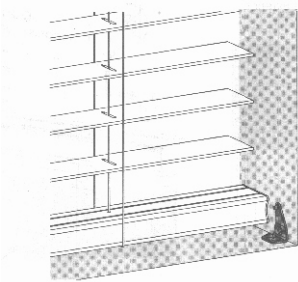

Outside Mount

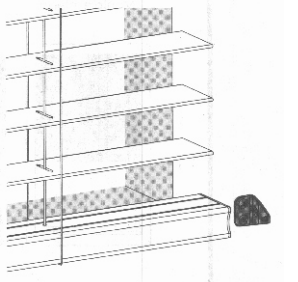

BREAKAWAY CONSOLIDATOR



Breakaway consolidators are provided on blinds with 3 or more raise/lower cords. The consolidator will be come pre-attached to your blind. if any reasonable weight is placed on the cords the breakaway consolidator will break apart. In the event of this, check that it is not damaged, re-insert the free cords and click the sections back together.

Young children can be strangled by loops in pull cords, chains tapes and inner cords that operate the product. To avoid strangulation and entanglement, keep cords out of the reach of young children. Cords may become wrapped around a child's neck. Move beds, cots and furniture away from window covering cords. Do not tie cords together. Make sure cords do not twist and create a loop.

Operating your blind:

Operating your blind is easy. Just follow these instructions.

- There are two controls that will operate the blind; a tilt control and a raise lower control.
- To raise the blind, pull the cord down until the blind is at the height you want and lock into place by moving the cord lock to the right.
- To lower the blind, release the cord by moving it to the right, then let the cord slide through your fingers.
- Slats should be open when raising or lowering the blind.
- To adjust the angle of the slats, operate the tilt control cords as required.

Safety tips:

There are things that you can do to reduce risk in your home.

- Move beds, cots and furniture away from the window.
- Do not let cords or chains hang loose. Make sure they are kept out of reach of children at all times.
- Do not tie loose cords and chains together.
- Check the condition of all safety devices if not used regularly and replace if the device is faulty.
- Replacements can be ordered.